

RACING & PERFORMANCE

RACING & PERFORMANCE

RACING & PERFORMANCE

RACING & PERFORMANCE

HOT ROD ALLEY

RESTORATION MARKETPLACE

RACING & PERFORMANCE

CONCESSIONS BELOW

EXHIBITOR SERVICE DESK BELOW

CONCESSIONS BELOW

Booths in the top section of the RACING & PERFORMANCE area include:

- Stewart Warner (2231)
- Moroso Performance Products Inc. (2241)
- Holly Performance Products (2251)
- Richmond Race Powertrain (2271)
- Hella Inc. (2281)
- Flex-a-Lite Consolidated (2291)
- Royal Purple (2311)
- Magnuson Products Inc. (2321)
- Jet-Hot Coatings (2331)
- House of Kolor (2341)
- NGK Spark Plugs (2361)
- Jet Performance Products (2371)
- Disc Brakes Australia (2381)
- Miller Electric Manufacturing Co. (2391)
- Bosch (2401)
- Lincoln Electric Company (2421)
- Goodridge (2431)
- Powermaster (2441)
- Filter International Ltd. (2451)
- VIAir Corporation (2461)
- HARD MEDIA Inc. (DSPORT) (2481)
- GMP (2491)
- CORSA Performance Exhaust (2501)
- Moser Engineering (2511)

Booths in the middle section of the RACING & PERFORMANCE area include:

- Hedman Heddies/Trans-Dapt (2233)
- Mr. Gasket Performance (2243)
- Edelbrock/Prestolite Performance (2263)
- COMP Performance Group (2239)
- Borla Performance Industries (2247)
- Eibach Springs Inc. (2267)
- B&M Racing & Performance Products (2263)
- Mothers Polishes & Waxes Cleaners (2246)
- Turbobonics (2265)
- Flowmaster The Exhaust Technology Company (2275)
- KONI North America (2285)
- SPAL USA (2296)
- Nitrous Express (2291)
- Vortech/Paxton (2305)
- KW Automotive North America (2306)
- Ground Force/Green Filter USA (2361)
- Specialty Auto Parts USA (2356)
- Energy Suspension (2365)
- 3M (2357)
- Ground Force/Green Filter USA (2361)
- Optima Batteries (2325)
- Painless Performance Products (2335)
- Motive Gear (2351)
- S&B Filters (2343)
- Covercraft (2334)
- TOKICO Performance Shocks (2324)
- Eaton Performance Products (2304)
- K&N Engineering Inc. (2294)
- Source Interlink Media (2274)
- GM (2374)
- MEQUIA'S INC. (2364)

Booths in the bottom section of the RACING & PERFORMANCE area include:

- Zoom Performance Products (2247)
- National Street Rod Association (2257)
- World Products (2267)
- Coker Tire (2277)
- Gear Vendors (2287)
- Goodguys Rod & Custom Association (2297)
- U.S. Radiator Corp. (2307)
- March Performance Inc. (2327)
- Hemmings Motor News (2337)
- Cone Engineering Inc. (2347)
- Dakota Digital Inc. (2357)
- Del City (2367)
- SoftSeal Inc. (2377)
- Lloyd Mats (2387)
- TriinParts Inc. (2407)
- Auto Custom Carpets Inc. (2417)
- Metro Moulded Parts Inc. (2427)
- Griffin Performance Products (2477)
- Eagle Specialty Products (2487)
- Cobra Seats/Sube Sports (2497)
- Volant Cool Air Intakes (2517)
- Grant Products (2237)
- Motorbooks (2248)
- LOKAR Performance Products (2278)
- Hot Rod Air Inc. (2279)
- Stainless Steel Brakes Corp. (2289)
- Billet Specialties (2299)
- IDIDIT Inc. (2299)
- PPG Automotive Refinish (2309)
- SEMA-HRIA/ARMO Councils (2328)
- Marquez Design (2359)
- Uniseer Performance Products (2369)
- Wysco Products (2369)
- AutoTrader Classics (2349)
- Classic Industries/OER (2379)
- Original Parts Group Inc. (2399)
- Custom Autosound Manufacturing Inc. (2419)
- Goodmark Industries Inc. (2429)
- Hyundai Motor America (2438)
- Auto Twirler (2459)
- Superior Axle & Gear (2469)
- Dimension Printing (2478)
- American Honda (2488)

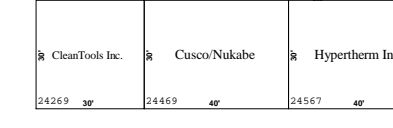
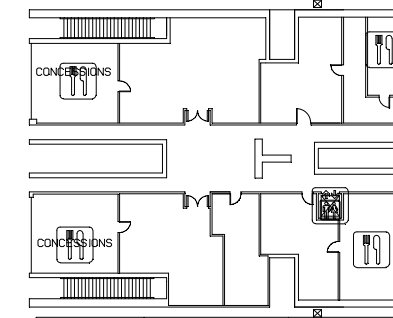

MOBILE ELECTRONICS & BUSINESS SERVICES

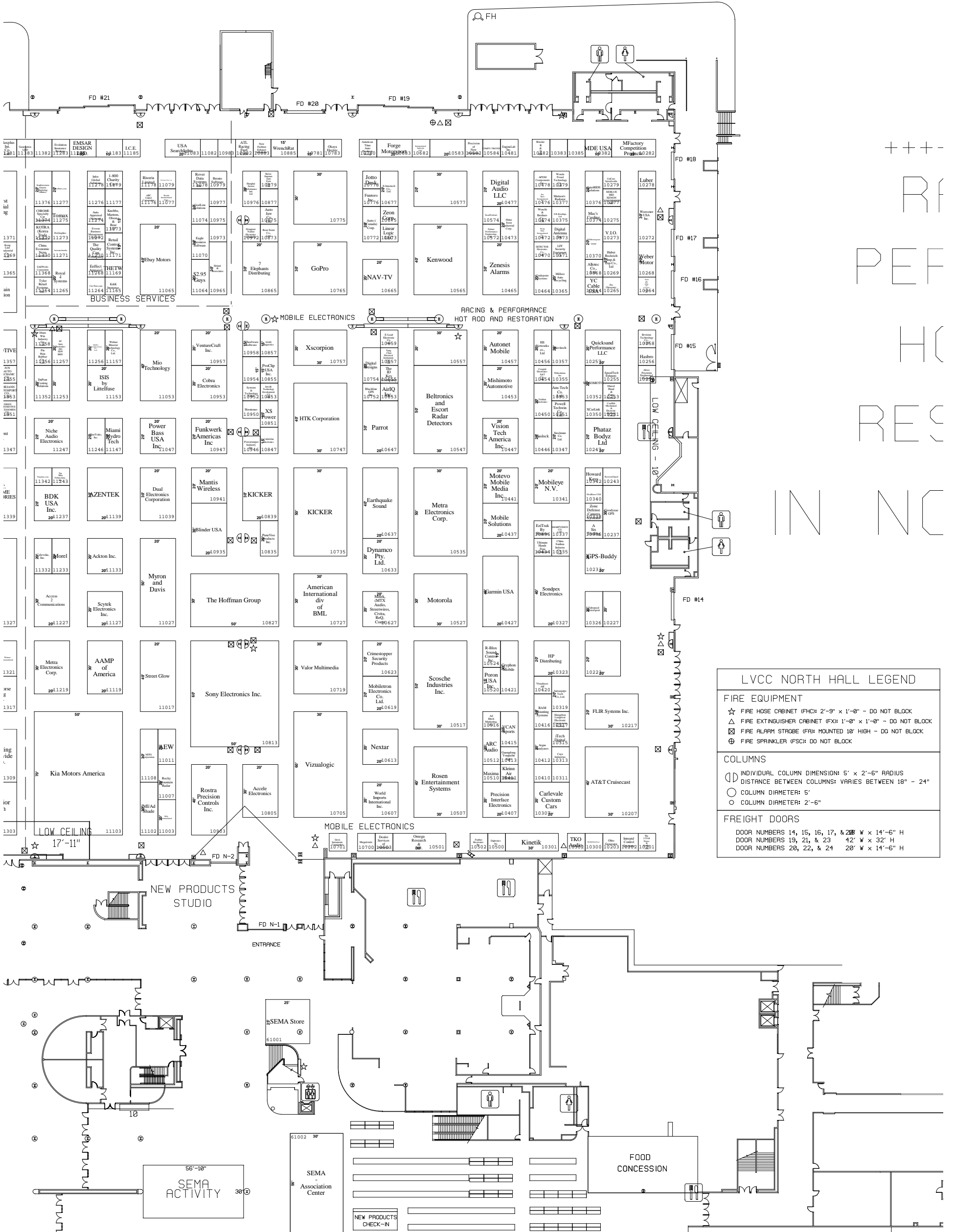

LVCC NORTH HALL LEGEND	
FIRE EQUIPMENT	
☆	FIRE HOSE CABINET (FHC): 2'-9" x 1'-0" - DO NOT BLOCK
△	FIRE EXTINGUISHER CABINET (FX): 1'-0" x 1'-0" - DO NOT BLOCK
⊠	FIRE ALARM STROBE (FAS): MOUNTED 18" HIGH - DO NOT BLOCK
⊕	FIRE SPRINKLER (FSC): DO NOT BLOCK
COLUMNS	
⊙	INDIVIDUAL COLUMN DIMENSION: 5' x 2'-6" RADIUS
○	DISTANCE BETWEEN COLUMNS: VARIES BETWEEN 18" - 24"
○	COLUMN DIAMETER: 5'
○	COLUMN DIAMETER: 2'-6"
FREIGHT DOORS	
FD #14, 15, 16, 17, & 20	W x 14'-6" H
FD #19, 21, & 23	42' W x 32' H
FD #20, 22, & 24	20' W x 14'-6" H

RF
PEF
HC
RES
IN NC

RACING & PERFORMANCE

TOOLS & EQUIPMENT RESTYLING & CAR CARE ACCESSORIES



MEDIA CENTER

11' H X 10' W (TELESCOPING)

S219 S220 S221 S222 S223

BLOGGERS LOUNGE SHOW OFFICE
S224 S225 S226 S227-N S227 S228

S229 S230 S231 S232 S233
CENTER FOR INTERNATIONAL COMMERCE INT'L VIP LOUNGE INT'L MARKETPLACE

TRUCKS, SUVs & OFF

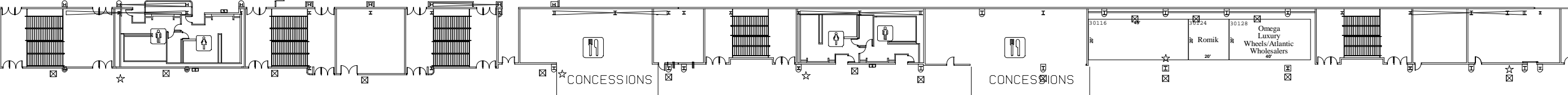
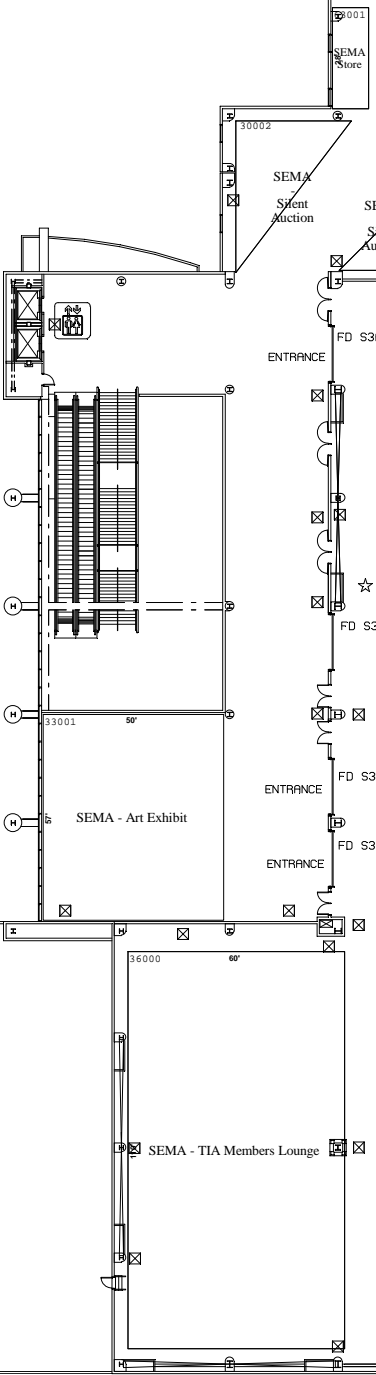

3001 20' Superwinch	30017 30' Wade Automotive	30025 20' DualLiner	30031 20' Rhino Linings Corporation	30035 20' MAXLINER	30037 20' Vision Motor Sports Inc.	3004 20' Mile Marker Inc.	3006 20' Ultimate Linings Polyurathene	3008 20' Crown Automotive Sales Co. Inc.	3009 20' Cross Tread	3010 20' Rampage Products	30109 20' Rize Industries	30113 20' Stabilus	30119 30' Carriage Works Billet Accessories	30124 20' Romik	30128 40' Omega Luxury Wheels/Atlantic Wholesalers	30133 20' All Sales Mfg. Inc./AMI	30141 30' CRE Products		
31005 30' Bushwacker Inc.	31013 30' Dee Zee Inc.	31021 30' Westin Automotive	31029 40' Warn Industries	31039 30' Putco Inc.	31047 50' Lund International	31059 40' Better Built	31077 50' Extang Corporation / Truxedo	31089 40' Skyjacker Suspensions	31099 50' Roll-N-Lock Corporation	31111 30' Superlift Suspension Systems	31129 40' Bedslide	31137 20' Bulletproof Suspension	31139 20' Reflexion Automotive	31141 20' Roadmax Automotive	31151 20' PapHut LLC	31155 20' Liner Co.	31159 30' Reflex Truck Liners		
33005 30' Vortex Sprayliners Inc.	33015 30' Dee Zee Inc.	33019 30' ANLUIS Raggini	33024 20' CARR	33031 20' Transfer Flow Inc.	33039 30' Hi-Lift Jack Company	33048 20' Owens Products Inc.	33053 20' Hi-Lift Jack Company	33060 20' Rugged Liner	33077 30' Coast to Coast International	33083 20' Turbo Liner Inc.	3309 20' Hopkins Manufacturing Corp.	33101 30' Sportz by Napier	3311 20' K&W Mfg.	33119 20' Reflexion Automotive	3312 20' Daystar Products	3312 20' Precision Grilles	33137 30' Traxxas	33147 40' B&W Trailer Hitches	33159 20' Iron Cross Automotive Inc.
34005 60' Bestop Inc.	34019 50' Winbo-Dongjian	34031 40' Coquent Towing Products	3404 20' KC HiLites Inc.	34047 60' Go Rhino/Products/Big Country Truck Accessories	34059 40' SEMA-LTAA Council	34067 35' Husky Liners	34079 30' MacNeil Automotive Products Ltd.	34101 40' Undercover	34111 40' Yakima Products Inc.	34123 30' STK LLC	34137 30' Line-X Spray-On Truck Bedliners	34145 60' Access Roll-Up Cover by ACI	34159 20' Toyota						
36004 30' BedRug by Wise	36004 30' Winch USA	36009 20' Benix USA	36012 20' Smokey-A-Way	36013 20' CALMINI Products Inc.	36018 30' Surco Products Inc.	36048 20' A-Ball	36052 20' Pop & Lock	36062 20' Stampede Products	3607 20' Ranch Hand Truck Accessories	3608 20' TRIMAX	3608 20' E&G Classics Inc.	3609 20' Heinger Automotive	36098 40' Omix-Ada/Rugged Ridge	36110 40' Kelderman Air Ride	3612 20' TeraFlex	36126 30' TracRac Inc.	3616 20' E-Z Loa Gat Inc.		
37004 40' ARB 4x4 Accessories	37012 40' Go Industries Inc.	37022 30' Snugtop	37030 40' Luveme Truck Equipment Inc.	37040 30' BAK Industries	37046 40' Delta Consolidated Industries	37056 30' Top Line Manufacturing Inc.	37064 20' Effects	37064 20' Products	3707 20' Arics Automotive	37082 30' ROUGH COUNTRY SUSPENSION	37088 30' Steelcraft	3709 20' Warrior Products	3710 20' Xanatos Automotive	3711 20' INNOVATIVE CAR RACKS	3712 20' Strona Industrial Inc.	37126 40' Scorpion Truck Bed Linings	37136 90' Toyota		
38004 60' Truck Accessories Group, LLC	38018 50' Curt Manufacturing	38030 30' SportChassis	38038 30' Powerful 4X4-Hua Dian	38046 50' TFP Inc.	38060 20' Big Time Auto Parts/Austin Int'l	38076 50' Master Lock Company	38086 40' Thule Towing / Valley	38098 60' Thule/SportRack/UWS	38112 30' Cognito Motorsports	38122 30' EZY-Lift	38130 20' Fab Fours Inc.								
39027 20' Kontrol Inc.	39502 20' Manufactory	39513 30' DU-HA, Inc.	39515 30' Hamsar Diverso Inc.	39539 30' Seiki	39543 30' DYNAPY	39555 20' DYNAPY	39559 20' UFWDA	39575 20' JACK-RACK	39577 20' Marketing	3958 20' Rage Powersport Products	39587 20' Woodshed Technologies	39603 20' Fuel Injection	39613 20' Baron/LFI	39621 20' Design	39627 20' Design	39629 20' Design	39631 20' Design		

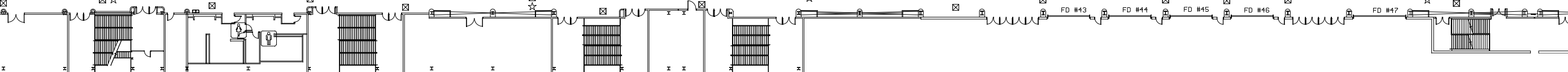

TIRES, WHEELS & EQUIPMENT

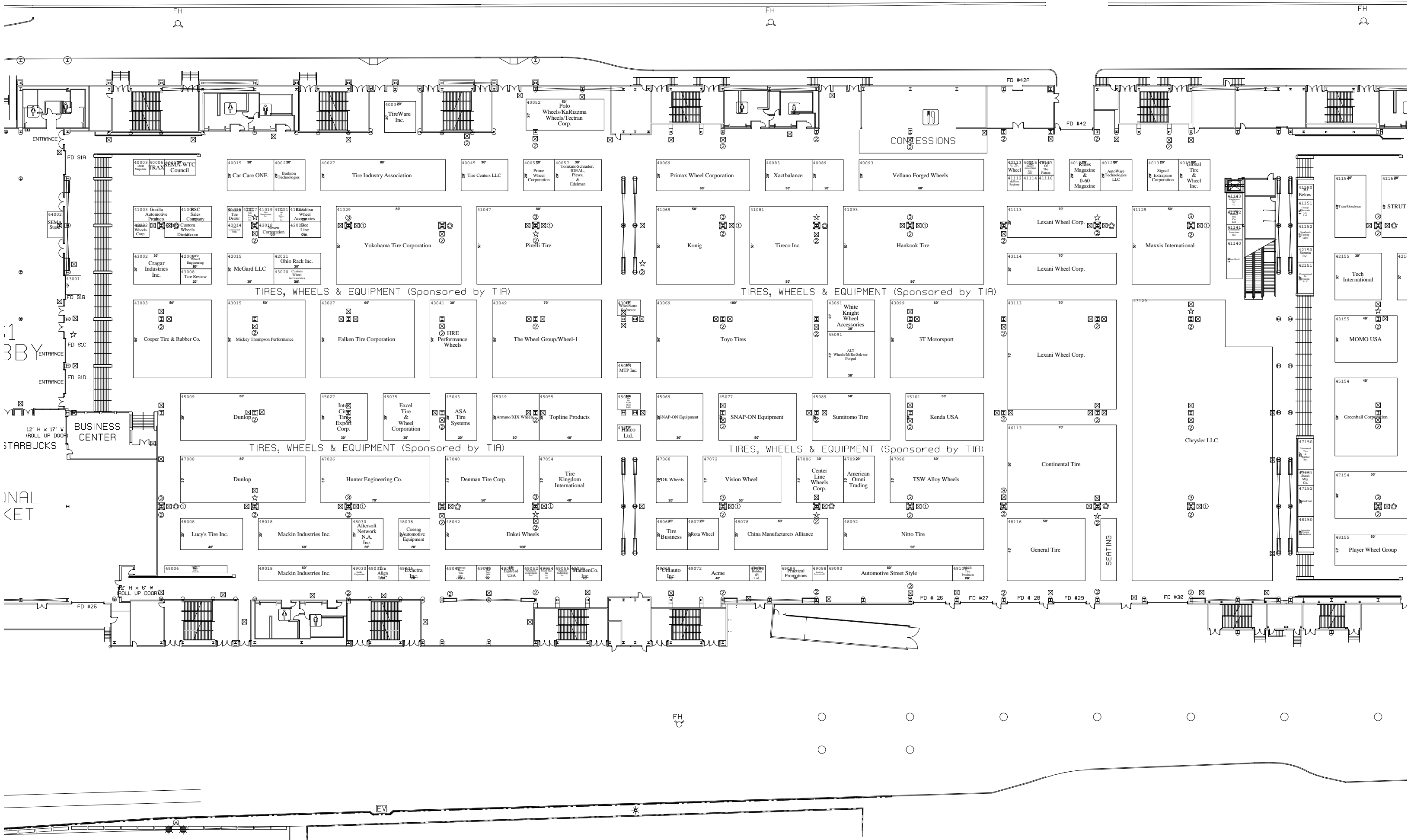

NT (Sponsored by TIA)

